

**FACILITY DATA**

FAC #	DESCRIPTION	ADDRESS	FAC #	DESCRIPTION	ADDRESS	FAC #	DESCRIPTION	ADDRESS	FAC #	DESCRIPTION	ADDRESS	FAC #	DESCRIPTION	ADDRESS
10242	Water Pump Facility	5036 Bayou Wy	10272	Fuel Farm	7330 Earhart DR	10294	Terminal A	6850 Airport Blvd	1285D	North Electrical Vault	7212 Earhart DR	12860	R/W 16L MALS Bldg & Elec. Servc	
10243	Parking Garage - Terminal A	6851 Airport Blvd	10273	Alternate Fuel Facility	7001 Airport Blvd	10295	Arco Service Center	6100 Airport Blvd	1285E	Terminal B	6900 Airport Blvd	1287F	Water Well No. 2	
10252	Air Services Building	7207 Earhart DR	10274	Faa Air Traffic Control Tower	5620 Alan Boyd DR	XXX	Cargo Sorting Facility	6651 Lindbergh DR	1285F	Concourse B	6851 Lindbergh DR	1287I	Irrigation Water Well	
10253	General Services Building	7201 Earhart DR	10275	National Service Facility	6230 McNair Cir	1251A	West Electrical Vault	6725 Lindbergh DR	1285G	Automated People Mover (APM)		1287K	Arff Sewage Lift Station	
10254	Daily Parking Lot	Use Fac 1254C	10276	Avis Service Facility	6520 McNair Cir	1251B	East Electrical Vault	6730 Aviation DR	1286A	RTR Electric Service		1287L	Biffy Dump	
10254	Economy Parking Lot	6300 Aviation DR	10277	Hertz Service Facility	6130 McNair Cir	1252A	Air Services/Elect. Storage Shops		1286B	RTR Generator Building		1287M	Water Well No. 6	
10254	Employee Parking Lot 51	6734 Aviation DR	10278	Cessna Citation	5850 Citation Wy	1252B	PBB Parts Storage		1286C	RTR Equipment Building		1293B	Modern Aviation	5885 Lear DR
10254	Hourly B Parking Lot	Use Fac 1254A	10279	Budget Service Facility	6420 McNair Cir	1254A	Toll Plaza B	5621 Alan Boyd DR	1286D	ALSF Complex		1299R	Airfield Equipment & Storage Facility	7225 Earhart DR
10254	Overflow / Free Waiting Parking Lot	5750 Crossfield DR	10280	Air Cargo Building	6733 Lindbergh DR	1254C	Toll Plaza A	6738 Earhart DR	1286E	R/W 34L Localizer Building				
10255	Fuel - Wash Facility	7330 Earhart DR	1280A	Air Cargo Maintenance Shop		1267A	Electricians Trailer	7238 Earhart DR	1286F	R/W 16R Inner Marker Building				
10256	Warehouse/shop Building	7215 Earhart DR	10281	Cargo Sorting Facility	6651 Lindbergh DR	1267B	Painters Trailer		1286G	R/W 16R Middle Marker Building				
10257	ARFF Building	7203 Earhart DR	10282	Alamo Service Facility	6320 McNair Cir	1267H	Taxi Trailer	5680 Crossfield DR	1286H	R/W 16R Glide Slope Building				
10258	Air Mail Facility U.s. Post Office	5853 Citation Wy	10283	FAA FIFO	6349 Lindbergh DR	1267L	Trailer 2-wide	7220 Earhart DR	1286I	R/W 34L Glide Slope Building				
10266	Rent-a-car Terminal	6327 Aviation DR	10285	Radio Equipment Bldg.		1267M	Trailer 4-wide Airfield Maint.	7222 Earhart DR	1286J	R/W 16R Localizer & DME Bldg				
10267	Operations Building	7001 Lindbergh DR	10288	Parks Maint. Wash Rack/Mix Stat.	6685 Lindbergh DR	1280A	Air Cargo Maintenance Facility	6729 Lindbergh DR	1286K	R/W 34L Middle Marker Building				
10268	Advantage Service Facility	6400 McNair Cir	10290	Sky Chef	6671 Lindbergh DR	1285A	Physical Plant Maint. Facility	6705 Lindbergh DR	1286L	R/W MALS Bldg				
10269	Enterprise Service Facility	6340 McNair Cir	10291	Corporate Hangar	5868 Flight Line Cir	1285B	Central Warehouse	6741 Lindbergh DR	1286M	R/W MALS Bldg. & Elec. Service				
10270	United Air Freight	6701 Lindbergh DR	10292	Corporate Hangar	5910 Flight Line Cir	1285C	Wildlife Building	7208 Earhart DR	1286N	R/W 34L VASI Power Transformer				

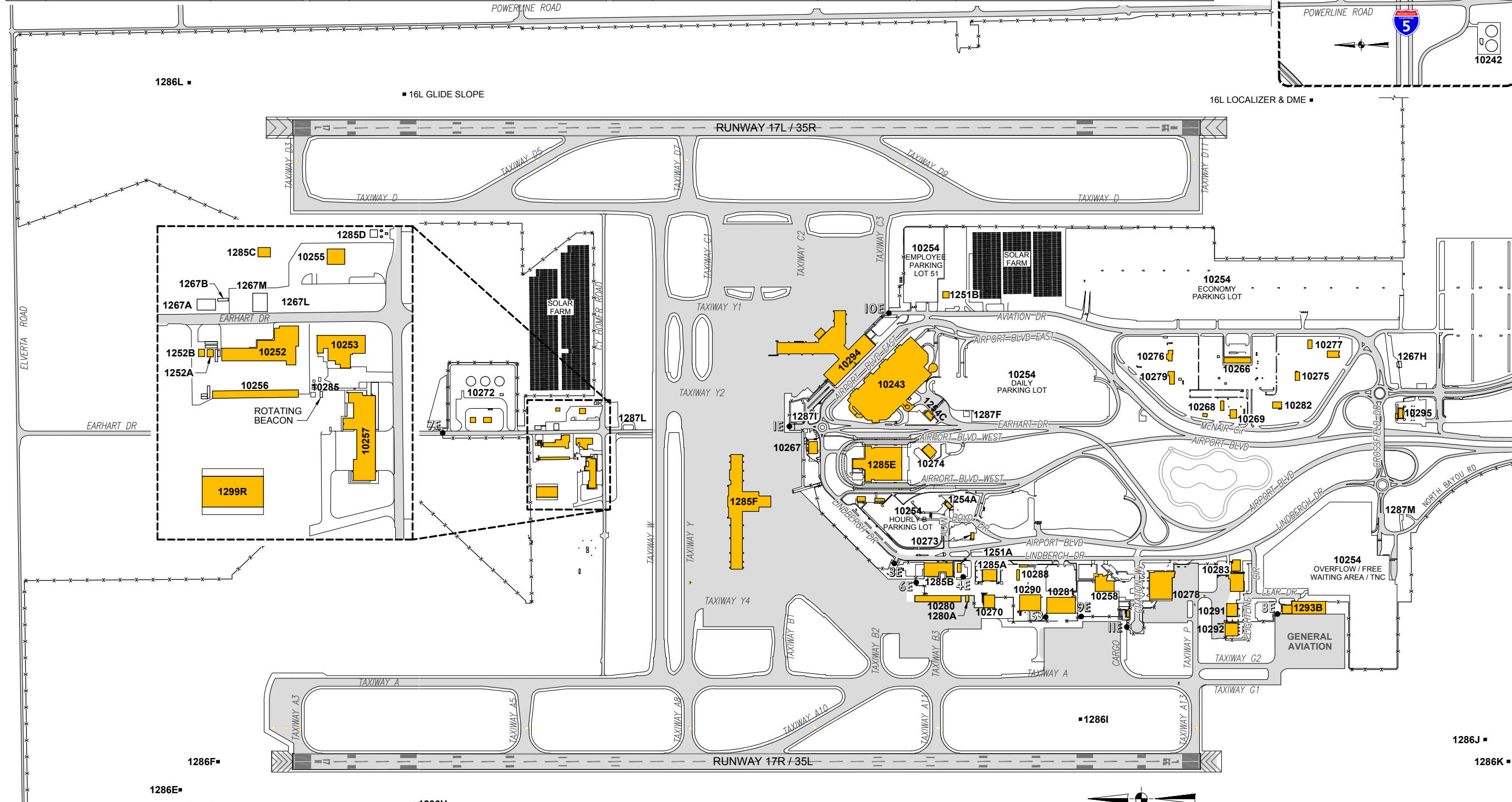
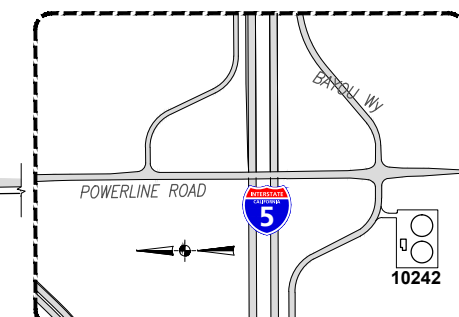

**REVISIONS**

NO.	DATE	DESCRIPTION

FILE NAME: CQ-10250-102  
 DRAWN BY: DSW  
 DATE: 11/2/00  
 DESIGNED BY:  
 CHECKED BY:  
 SCALE:  
 NO SCALE  
 LINE IS 2 INCHES AT FULL SIZE (IF NOT 2" SCALE ACCORDINGLY)

**SACRAMENTO INTERNATIONAL AIRPORT**

SHEET TITLE  
**AIRPORT FACILITIES LAYOUT**

DRAWING NO.  
**CQ-102**  
 SHEET NO. 1 OF 1

Updated: 8/13/2024 - Printed: 11/15/2024 7:07:37 AM By: Wilson, Don  
 File: V:\Facility\SMF\10250 - SMF\Sheets\CQ100\CQ-102-50-102.dwg (Tab: Facilities)

**FACILITY LAYOUT PLAN**

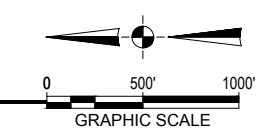

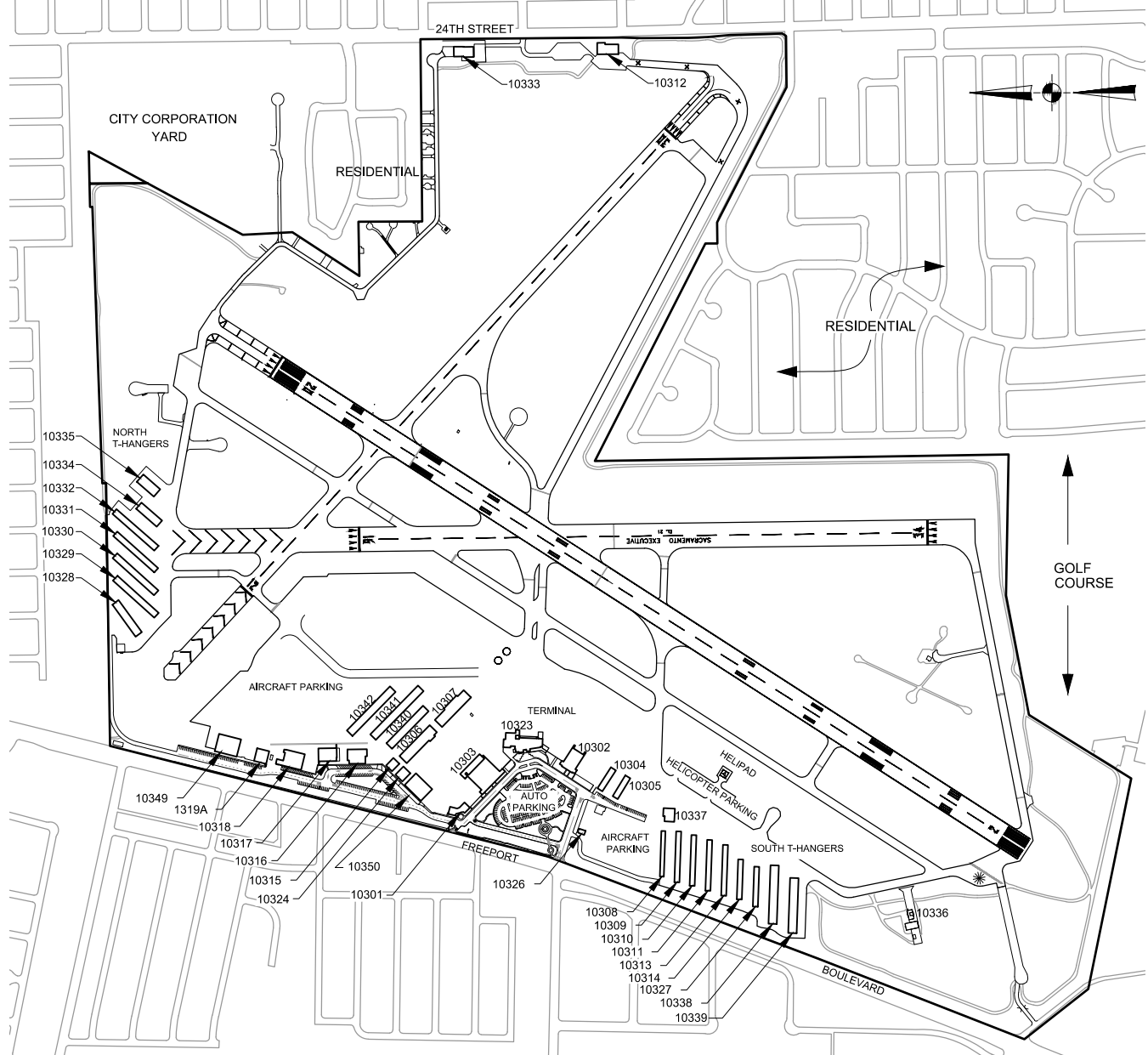

### DATA / LEGEND

FACILITY	DESCRIPTION
10301	SACJET AVIATION
10302	EXECUTIVE AIR REPAIR
10303	SACJET AVIATION HANGAR
10304	T-HANGARS
10305	T-HANGARS
10306	SACJET T-HANGAR
10307	SACJET T-HANGAR
10308	T-HANGARS
10309	T-HANGARS
10310	T-HANGARS
10311	T-HANGARS
10312	VACANT
10313	T-HANGARS
10314	T-HANGARS
10315	VACANT
10316	CARTWRIGHT AERIAL SURVEY
10317	IVANAIR
10318	EVA FLIGHT TRAINING ACADEMY
1319A	CALIFORNIA DEPARTMENT OF FISH AND GAME
10323	AIRPORT TERMINAL BUILDING
10324	MYER PACIFIC INS / ATP
10326	SHERIFF'S AIR SQUADRON
10327	T-HANGARS
10328	T-HANGARS
10329	T-HANGARS
10330	T-HANGARS
10331	T-HANGARS
10332	T-HANGARS
10333	RADMAN AERIAL SURVEYS
10334	T-HANGAR
10335	T-HANGARS
10336	FUEL FARM
10337	AIRBORNE ELECTRONICS
10338	T-HANGARS
10339	T-HANGARS
10340	SHADE HANGARS
10341	SHADE HANGARS
10342	SHADE HANGARS
10349	EXECUTIVE AUTOPILOTS
10350	SACJET HANGAR

DRAWING: EXH-FAC-TENANT

DRAWN BY: ManzyukP

## SACRAMENTO EXECUTIVE AIRPORT FACILITIES AND HANGARS

SHEET: 1 SCALE: N.T.S.

DATE: 11/12/2010



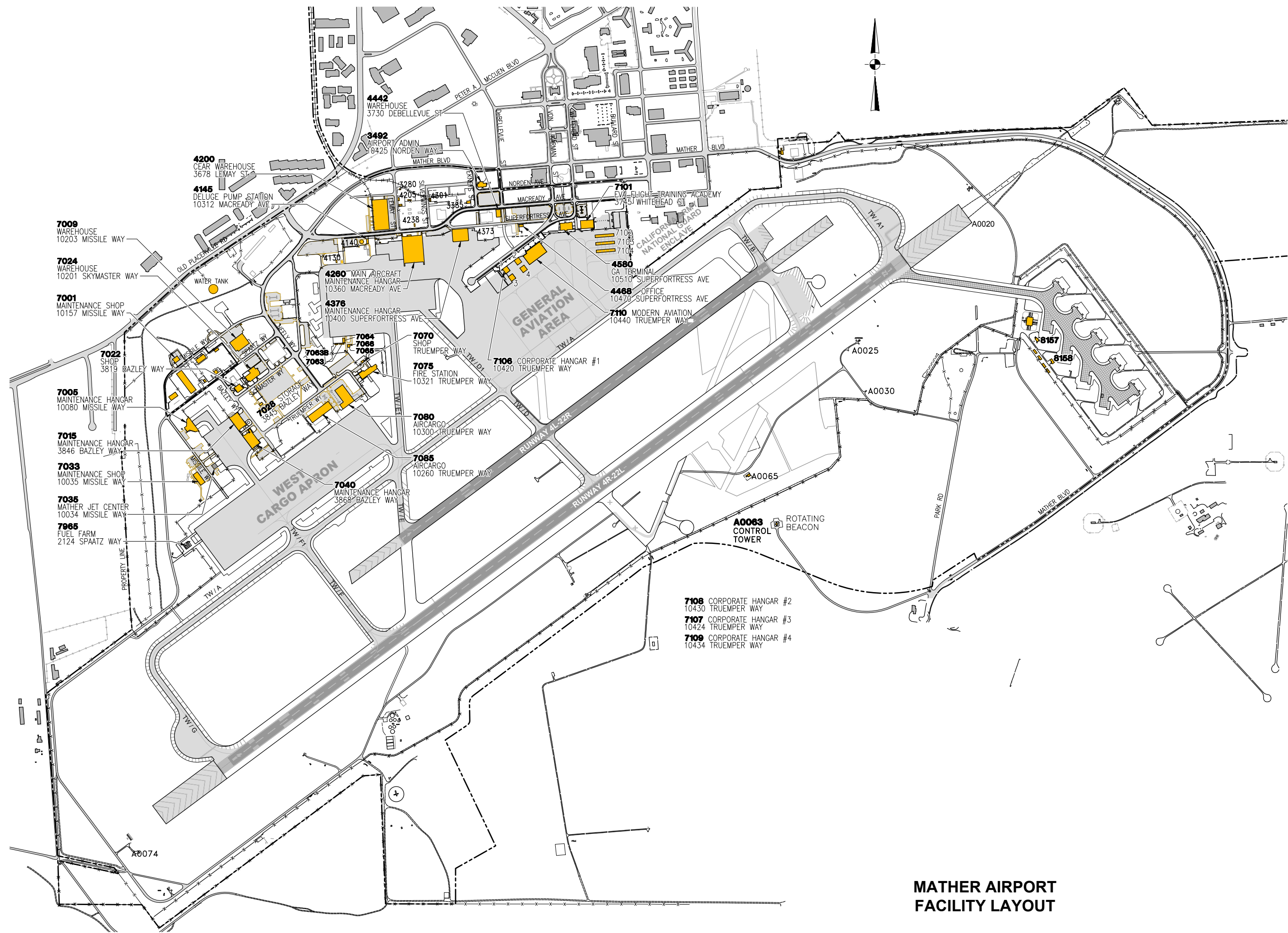

**MATHER AIRPORT  
 FACILITY LAYOUT**

REVISIONS		
NO.	DATE	DESCRIPTION

FILE NAME: CR-MHR-101  
 DRAWN BY: WilsonDS  
 DATE: 2/22/2006  
 DESIGNED BY: WilsonDS  
 CHECKED BY:  
 SCALE:  
 NO SCALE  
 LINE IS 2 INCHES  
 AT FULL SIZE  
 (IF NOT 2" SCALE ACCORDINGLY)

**SACRAMENTO  
 MATHER  
 AIRPORT**

SHEET TITLE  
**AIRPORT FACILITIES LAYOUT**

DRAWING NO.  
**CR-MHR-101**  
 SHEET NO. 1 OF 1

Updated: 8/23/24 - Printed: 11/15/24, 7:11am By: WilsonDS  
 File: V:\Facility\MHR0000 - MHR\Sheets\CDCR\MHR-101.dwg (Tab: Facility Map)