

Sacramento International Airport

SMForward Design RFQ/E

Industry Day Presentation

November 2, 2022



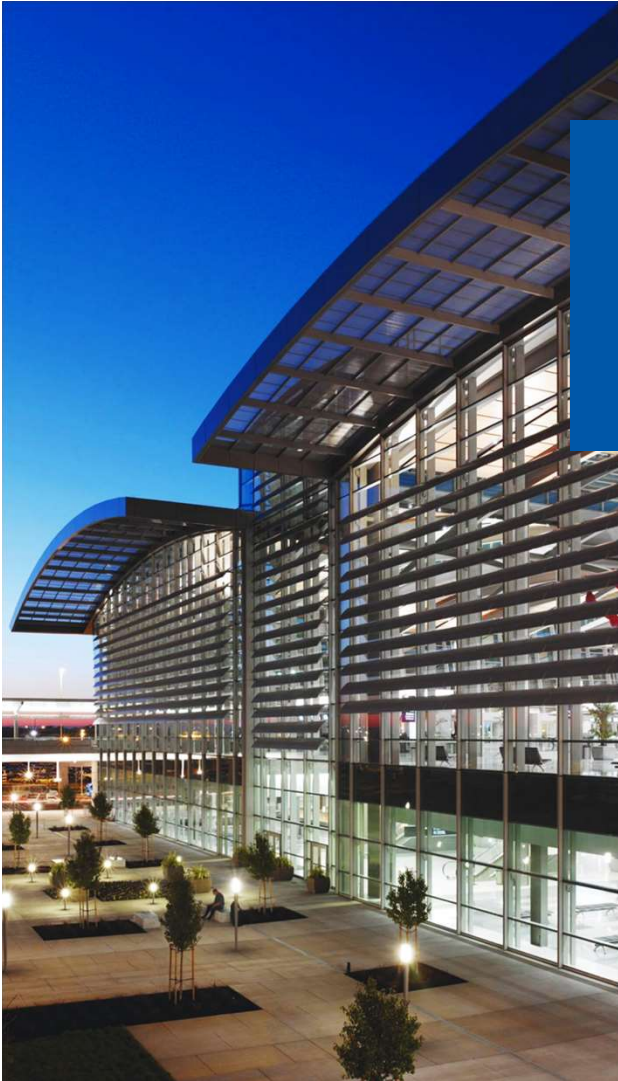

Agenda

- 1. Introduction & House Keeping**
- 2. Solicitation**
- 3. Project Overview**
- 4. Design RFQ/E Milestones**
- 5. Other SMForward Projects**
- 6. Questions**



Introduction & House Keeping



Solicitation

RFQ/E Highlights

- The Department is soliciting Statements of Qualifications and Experience (SOQ&E) from qualified Architectural and Engineering Designer of Record firms (DOR) to provide architectural and engineering design and technical support services during construction for the Project.
- Maximum Contract Values is \$35 million.
- Initial term of five (5) years, with two (2) options to extend the term for one (1) additional year, for an anticipated total term of seven (7) years.
- Describe in the SOQ&E how small, disadvantaged, minority and women, and locally-based businesses would provide meaningful professional and technical services.
- RFQ/E is posted on www.sacramento.aero.
- One or more CMAR to deliver SMForward Airside Projects

Project Overview



Sacramento International Airport Growth Projection

- 2022 Sacramento International Airport (SMF) passenger traffic has returned to 95% of 2019 passenger level (Historical Peak)
- Projected to surpass 2019 passenger traffic by 2023
- July 2022 had the 2nd highest monthly pax volume of all times
- Near-Term Projects will be referred to as **SMForward**
- Planned to meet, at a minimum, Planning Activity Level 2 (PAL 2) passenger traffic

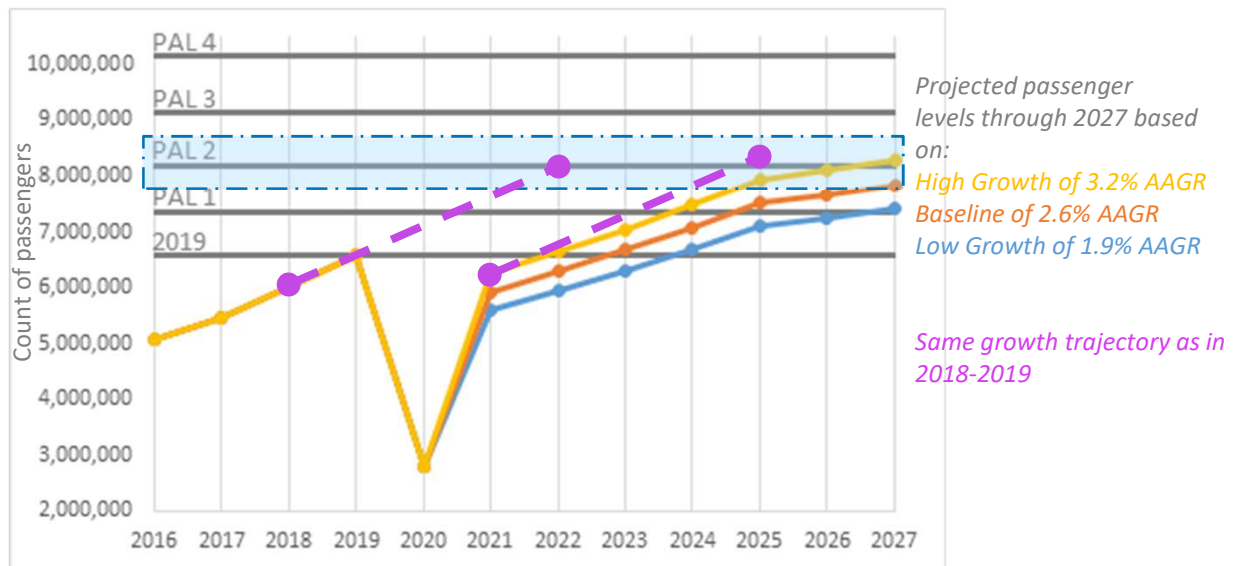

- PAL 1: 7.4M enplaned passengers
- PAL 2: 8.2M
- PAL 3: 9.2M
- PAL 4: 10.2M

SMForward Airside Projects

Below are the projects covered by this contract

1. Additional 6-8 Gate
 - Evaluating Concourse B and Concourse A alternatives
2. Terminal A Expansion
 - Space for additional ticket counters, baggage claim carousel, space for BHS modification and improvements, and office space
3. Pedestrian Walkway
 - ADA-compliant connection between Terminal B and Concourse B
 - Connection for future concourse

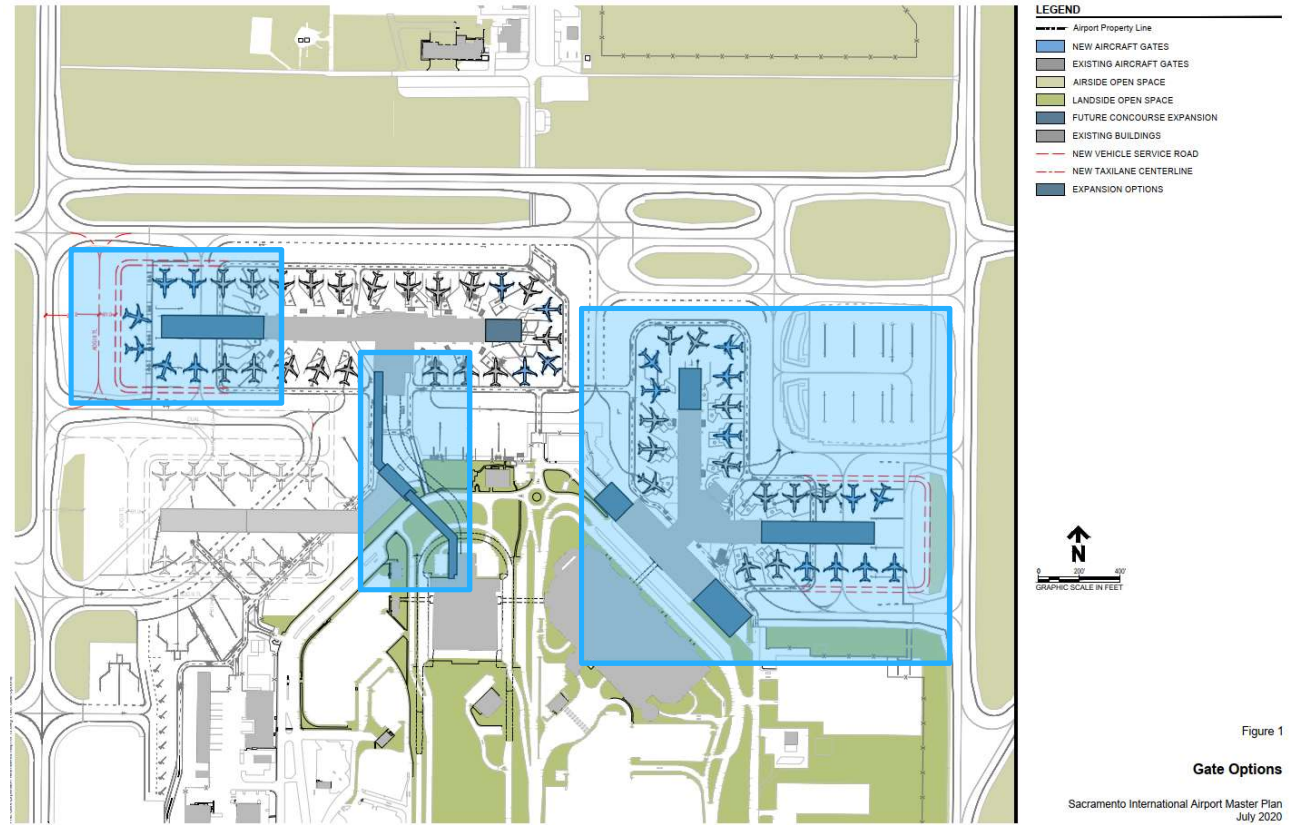

Progress Update – Airside Projects

- ➔ Terminal B to Concourse B Pedestrian Walkway
 - ❑ Conceptual Design to be completed on Nov. 18
 - ❑ A/E RFQ/E underway
 - ❑ Project Budget: \$130 Million
 - ❑ NEPA clearance: Seeking Categorical Exclusion
 - ❑ CMAR project contracting and delivery method; Issue RFQ/E for CMAR in Q1 calendar year 2023
- ➔ Additional Gates & Terminal A Expansion
 - ❑ Project Budget: \$300 Million
 - ❑ A/E RFQ/E underway
 - ❑ NEPA clearance: Environmental Assessment
 - ❑ CMAR project contracting and delivery method; Issue RFQ/E for CMAR in Q1 or Q2 calendar year 2023

Pedestrian Walkway Conceptual Design

INITIAL DEDICATED WALKWAY - PLAN

GOALS

- Delay Future Decisions
- Constructability
- 'Relate' to APM Guideway
- Value and Budget
- Customer Experience

PROGRAM: DEDICATED

- 66,773 S.F. Total
 - 22,843 S.F. Upper Walkway
 - 24,750 S.F. Hub
 - 19,180 S.F. Lower Walkway
- 35' Lower & 45' Upper Walkway Widths
- 4 Moving Walkways (230' & 320')
- 4 Escalators
- 2 Pax Elevators + 1 Service Elevator

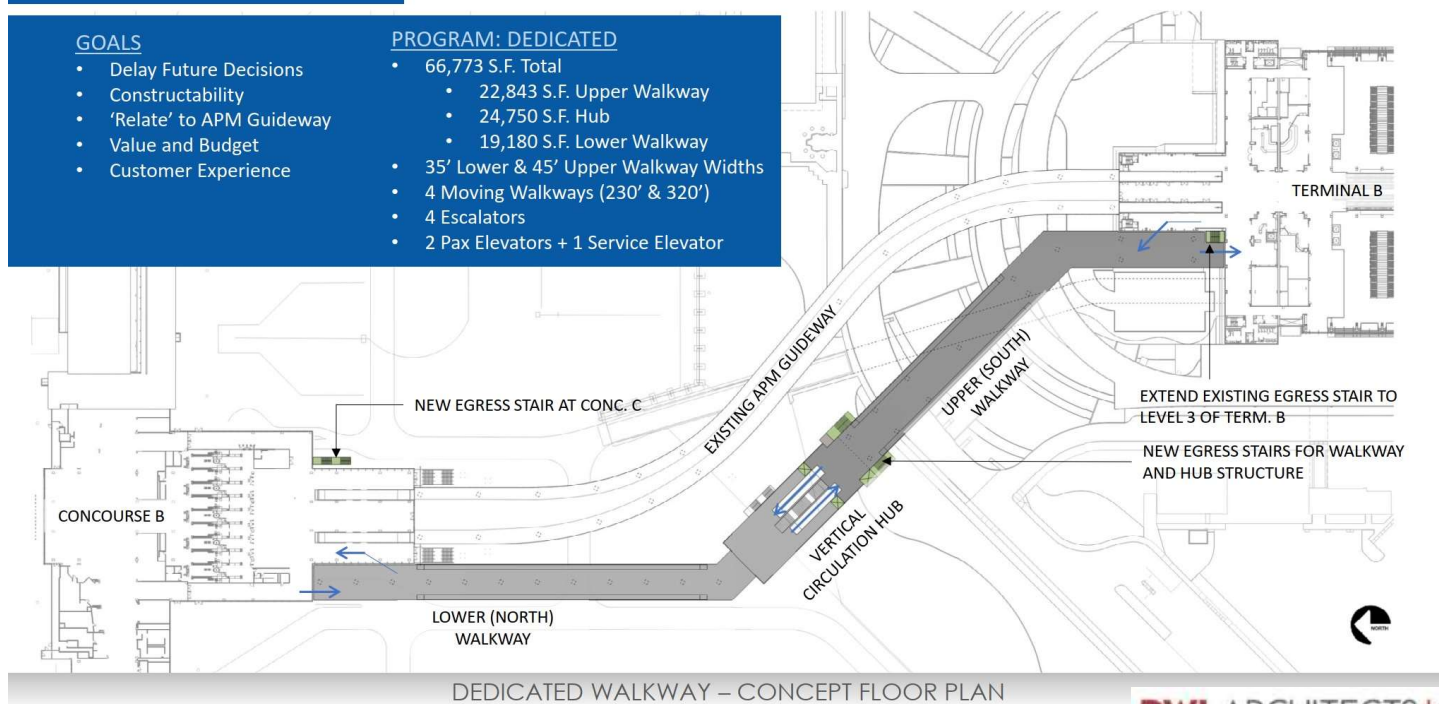

DWL ARCHITECTS+

Pedestrian Walkway Conceptual Design

DEDICATED WALKWAY DEVELOPMENT – REFINEMENT

HUB DESIGN 01



HUB DESIGN 02

DWL ARCHITECTS+

Pedestrian Walkway Conceptual Design

DEDICATED WALKWAY - RENDERINGS

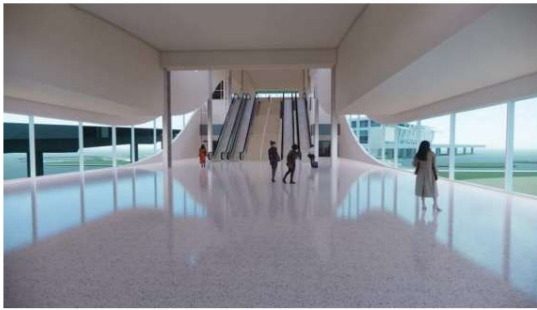

DWL ARCHITECTS+

Concourse B West Pictures

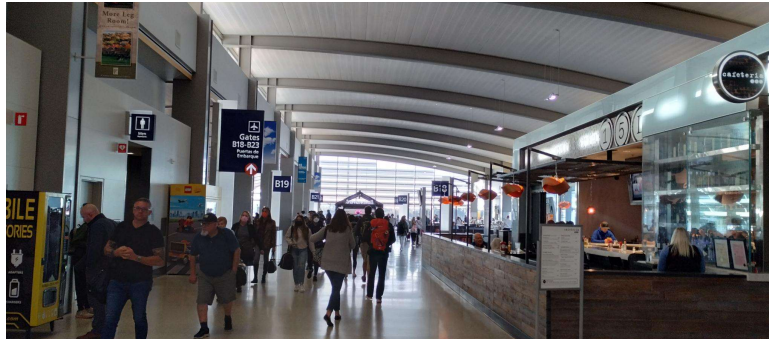

Terminal A Ticketing Area Pictures

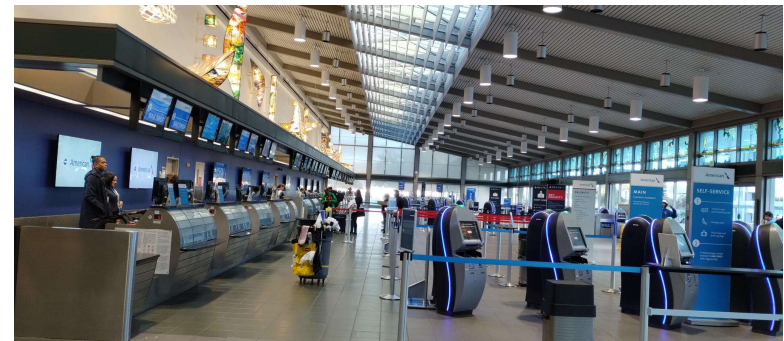
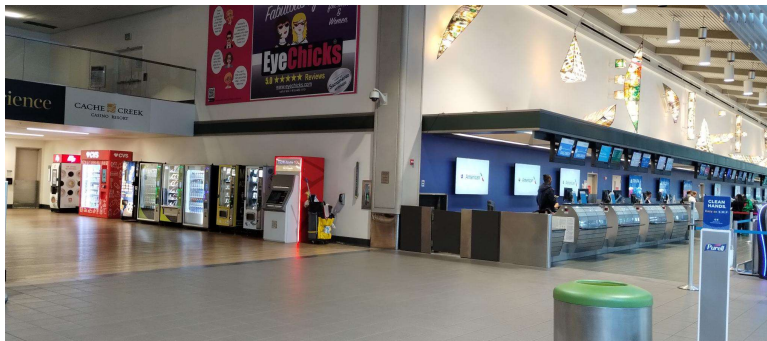
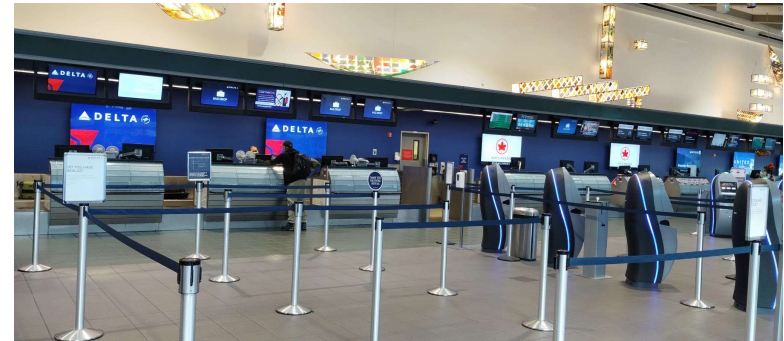
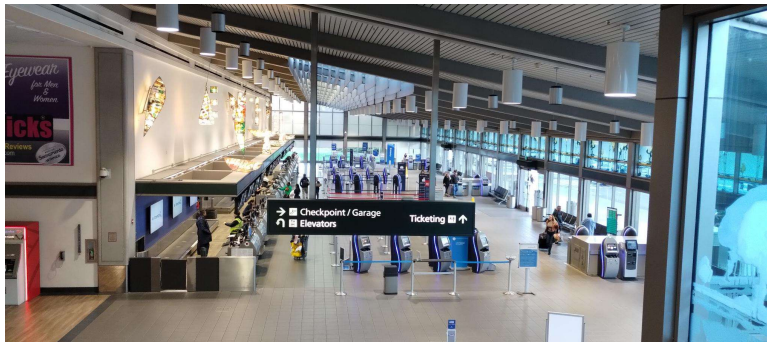

Terminal A Baggage Claim Area Pictures

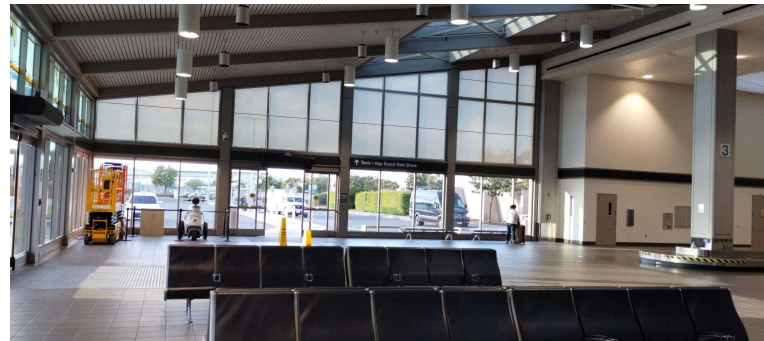
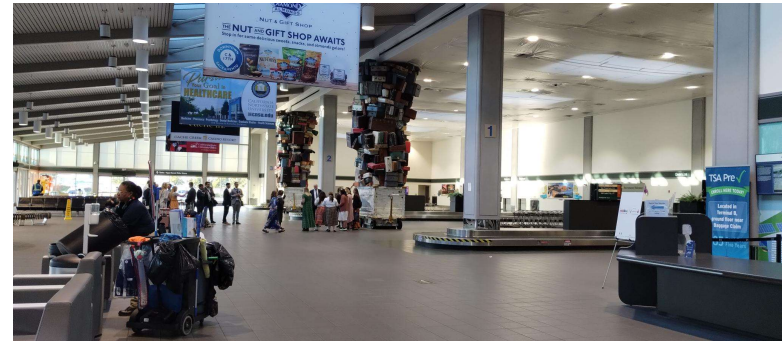
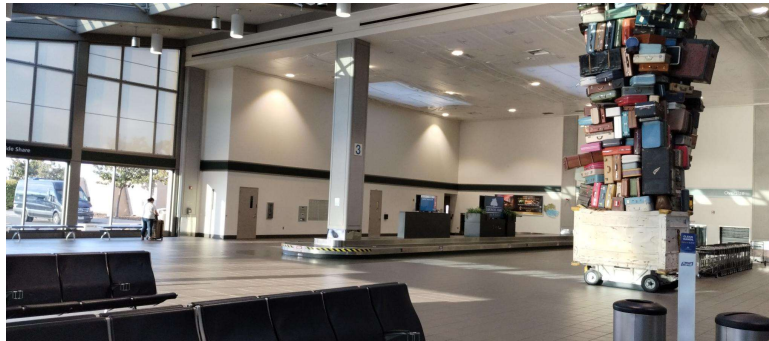

Concourse A North Pictures

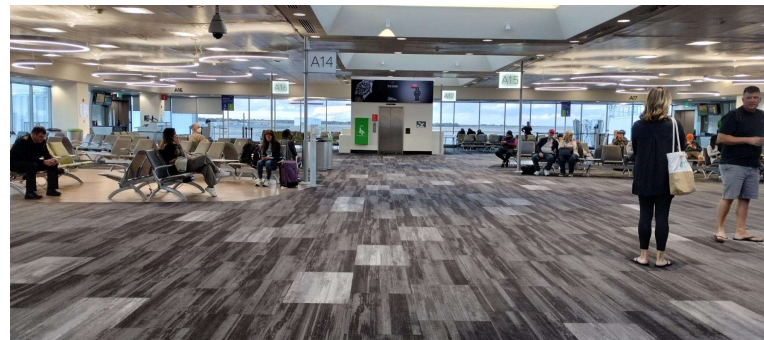

Concourse A East Pictures

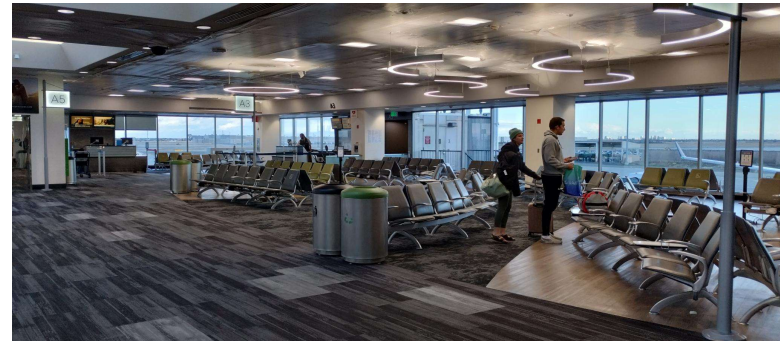
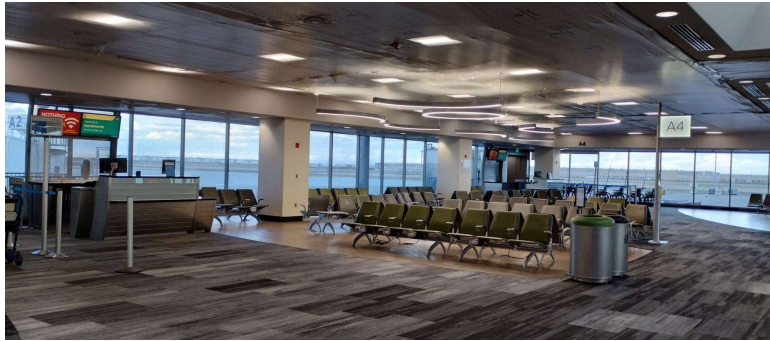

Design RFQ/E Milestones

A large, faint, light blue graphic in the background of the slide. It consists of a stylized globe with a star or compass rose design overlaid on it. The globe is composed of several curved segments, and the star has five points. The entire graphic is centered behind the text.

Design RFQ/E Milestones

Dates	Event
October 27, 2022	Issuance of RFQ&E
November 2, 2022	Industry day presentation (Optional)
November 23, 2022	Deadline for submitting questions
December 2, 2022	Addenda Issued, if necessary
December 20, 2022	SOQ&E due date
January 5, 2023	Interview invitation letters sent to proposers
January 18 - 19, 2023	Interviews
March 21, 2023	Recommendations of selection presented to Board
April 4, 2023	Effective date of agreement with selected proposer

The background of the slide features a large, faint, light blue logo. The logo consists of a stylized 'S' and 'F' intertwined, with a star-like shape in the center. The text is white and centered over the logo.

Other SMForward Projects

(Not Included in this RFQ/E)

SMForward Landside Projects

Consolidated Rental Car Facilities (ConRAC), **F & G**

- Preferred location from 2019/2020 parking analysis - to be confirmed with RAC industry input

New Terminal A Exit Road & Ground Transportation Center (GTC), **A & B**

- 2019/2020 parking analysis concluded that existing GTCs can be consolidated

New Parkign Garage located west of Terminal B

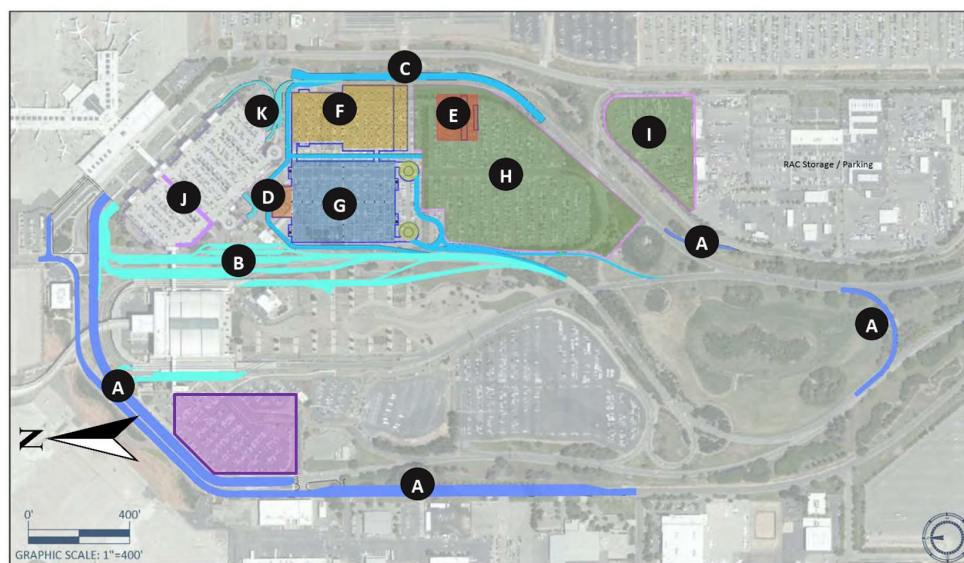

	Description	SF
A	Airport Roadway Improvements (Terminal A Exit Roadway and Terminal Return Access)	254,470
	Airport Roadway Improvements (Parking Lot)	61,500
B	Airport Roadway Improvements (GTC)	341,030
C	ConRAC Roadway Improvements	75,550
D	Customer Service Building (CSB) Footprint	16,000
E	Heavy Maintenance Facilities Parking	40,000
	Heavy Maintenance Facilities Workshop	10,000
F	QTA - Quick Turn Around Area	603,500
	QTA - Internal Ramp / Helix	25,260
	QTA - Bridge to Ready Return	3,960
G	RR - Ready Return	926,500
	RR - Helix	7,680
	RR - Entrance Roadways	24,030
	RR - Exit Roadways	16,060
H	RR - Fire Lane	46,850
	Surface Parking (adjacent)	658,760
I	Surface Parking (remote)	194,280
J	Garage A - Pedestrian Corridor	12,170

Progress Update – Landside Projects

- Consolidated Ground Transportation Center & New Terminal A Exit Roadway
 - ❑ Design Consultant: ARUP
 - ❑ Project Budget: \$75 Million
 - ❑ NEPA clearance: Seeking Categorical Exclusion
 - ❑ CMAR or traditional Design-Bid-Build project contracting and delivery method
- Terminal B Parking Garage
 - ❑ 3400 – 5500 Space
 - ❑ Project Budget: \$200 Million
 - ❑ Initiated the development of Project Criteria Document
 - ❑ NEPA clearance: Seeking Categorical Exclusion
 - ❑ Design-Build (DB) project contracting and delivery method
 - ❑ Issue RFQ/E for DB in Q2 calendar year 2023
- New ConRAC
 - ❑ Earliest construction start date is 2025
 - ❑ Project Budget: \$300 - \$400 million
 - ❑ CFC Collection in place



Thank You!
Questions?